

TOSHIBA

OWNER'S MANUAL

INSTRUKCJA OBSŁUGI

BEDIENUNGSANLEITUNG
DES BESITZERS

Air Purifier
CAF-X50XPL
Oczyszczacz powietrza
CAF-X50XPL
Luftreiniger
CAF-X50XPL

Please Read This Manual

Inside you will find many helpful hints on how to use and maintain your Air Purifier properly. Just a little preventive care on your part can save you a great deal of time and money over the life of your Air Purifier.

Należy przeczytać tę instrukcję

Wewnątrz można znaleźć wiele przydatnych wskazówek dotyczących prawidłowej obsługi i konserwacji oczyszczacza powietrza. Załedwie kilka środków zaradczych ze strony użytkownika umożliwia zaoszczędzenie mnóstwa czasu w ciągu całego okresu użytkowania oczyszczacza powietrza.

Bitte lesen Sie dieses Handbuch

Auf den Innenseiten finden Sie viele hilfreiche Tipps, wie Sie Ihren Luftreiniger richtig verwenden und pflegen können. Ein wenig präventive Pflege von Ihrer Seite kann Ihnen während der Nutzungsdauer Ihres Luftreinigers viel Zeit und Geld sparen.



Union Distribution s.r.o.; Rosmarin Business Center;
Delnická 21312/, Praha 7; Czech Republic

*Product colour and image may vary from the actual product.

*Kolor i wygląd produktu mogą różnić się od produktu rzeczywistego.

*Die Farbe und das Bild des Produkts könnten vom tatsächlichen Produkt abweichen

Dear Customer,

Welcome to the Midea family!

We thank you for your patronage and invite you as a member of our sizable global fraternity. Midea, being one of the world's largest manufacturers of Air-Conditioners and Home Appliances with a presence in over 190 countries, confidently delivers to you world class product solutions.

Midea was founded on the values of trust and assurance and all our products and services reflect that ideology. It's our contest endeavour to facilitate your access to information, products and services as well as to make sure that any and all of your queries or grievances get resolved satisfactorily.

You can register your service request at our Toll Free number **1800-3000-0011** or email us at **mideacare@carriermidea.com**. Please include the unique 'customer relationship number' that has been allotted to your query in the subject line to me.

Feedback from our valued customers always helps us to improve. Do write to us with suggestions about our product and services. I would be happy to receive them by mail. We sincerely hope that you enjoy the style and comfort that comes along with owning a Midea product. I look forward to build a relationship with you on the tenets of trust and quality.

Best Regards!

Sanjay Mahajan

Chief Operating Officer

Carrier Midea India Pvt. Ltd.

Table of Contents

Check on receiving.....	3
Key Features	4
Instructions before use	5
Operation (Model - CAF-X50XPL).....	8
Know your Air Purifier (Model - CAF-X50XPL).....	9
Maintenance	14
Troubleshooting	16
E-Waste Management Guidelines.....	18
Product Warranty Terms & Conditions.....	19
Memo	22
Warranty Card.....	23

Check on Receiving

On receiving your Toshiba Air Purifier

Toshiba adopts a stringent policy to ensure safe delivery of all its products. All product shipments are thoroughly checked, packed and quality certified before leaving our manufacturing. Please don't accept any product if there is any visible loss or damage of the goods and ask the delivery person to make the note on the freight bill or receipt.

On Opening the box

When a shipment has been delivered to you in apparent good conditions, but upon opening the box, if there is any loss or damage that has taken place due to transit, please inform the Union Distribution s.r.o. service centre immediately.

About your instruction/usage manual

This manual is a guide to good usage and operating instructions for your new Toshiba Air Purifier.

This manual does not contain all product service related procedures required for continued successful operation of this product. The services of Toshiba Authorized Service Person must be employed on periodical basis for the same.

Do not operate the product before reading the manual supplied with this product and follow instructions to ensure personal safety and proper operation.

Union Distribution s.r.o. assumes no liability for installation performed by any unauthorized Person.

Always install, operate, inspect and maintain this product in accordance with all applicable standards.

Please store this user manual carefully for any future reference.



Key Features



TRI-SHIELD TECHNOLOGY WITH HEPA FILTER

Toshiba Air Purifiers uniquely combine 3 different filtration layers; a pre-filter, a HEPA filter and an activated carbon filter, to assure remarkable filtration power down to the last micron.



IONIZER

The Ionizer releases negative ions to eliminate odour, dust, smoke and pollen particles to give you fresh and healthy air, it also makes the air beneficial for people suffering from respiratory ailments, allergies as it reduces allergens in the air.



HIGHER CLEAN AIR DELIVERY RATE (CADR)

With a higher CADR (170 m³/h**) than others, Toshiba Air Purifiers deliver purer and fresher air to all corners of your indoor environment.

**For model detail refer website



ENERGY EFFICIENT & LOWER NOISE LEVELS

Toshiba Air Purifiers give you maximum performance with minimum power consumption (45W). The ultra-low noise level will ensure your family sleeps undisturbed.

Instructions before use

If the power socket used to power the appliance has poor connections, the plug of the appliance becomes hot. Make sure that you plug the appliance into a properly connected power socket.



Must be repaired by professionals.

Non-professionals and unauthorized repairmen should not repair or transform this machine.



Please do not operate with wet hands.

Operating with wet hands may result in electric shock.



When do cleanings, please stop operation and turn off the machine.

Prevent accidental electric shock due to electric leakage.



Please do not Insert things to the air inlet and outlet

There is a wind wheel rotating at a high speed, so prevent accidental injury and damage of machine.



Do not put air purifier to the place where there is flammable and combustible air. Avoid long-term direct sunshine.



Do not use at the place where it is humid and easy to contact water, such as bathrooms.

Prevent electric shock.

Instructions before use



Do not exchange power cords without authorization.
If power lines are broken, please ask local service network for help with maintenance.



Never place this machine on inclined surfaces.
If the machine falls, may cause damage to the machine body or inner parts.



Do not use this machine in environment with oil and smoke, such as kitchens
May damage machines.



Do not use this machine at outdoors.

Safe Placement

Please read the following correct placement methods, thus avoiding failure in the use process.

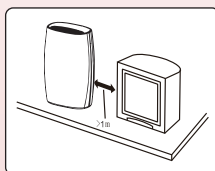

1. Please keep this machine at least 1 meter away from televisions, radio and other appliances.

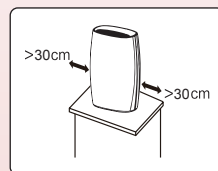

2. Please keep this machine atleast 30cm away from all sides.

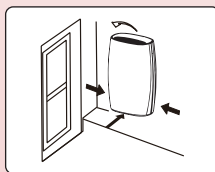

3. Please place this machine in a place facilitating air circulation.

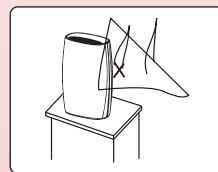

4. Please don't place this machine near the curtains.

Instructions before use

Tips: When installing filter, Please turn off power first, Please make sure the correct installation of filter and back side. At the first time, please remove packaging bags of filter components.

1. Remove back cover

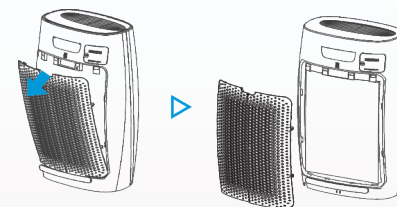

Grasp the handle of back cover, pull out and raise Up the handle, then you can remove back cover.

2. Remove filter component

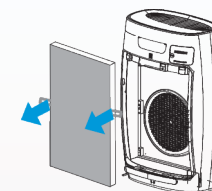

Hold both sides of filter components with two hands, then remove them.

3. Install filter components

Remove the packaging bags of filter components



Install filter components according to the direction of arrow on the top of the filter.

4. Install rear cover

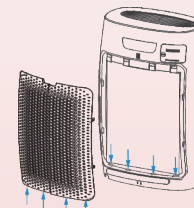

Insert buckle of rear cover to slot of the be bottom of the machine.

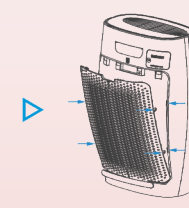

Press right and left sides of the machine with hands, and inert 4 buckles to the inside of the machine.

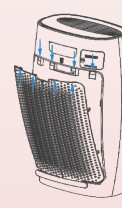

Press the bottom of the machine with hand, and insert 4 buckles to the inside of the machine.

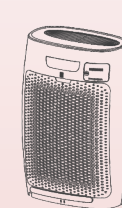

Finish the installation of rear cover.

Operation (Model - CAF-W50XIN)

2. Release the button after reaching the required sensitivity.

Note:

1. The "Big, Medium and Small" of the odor sensitivity intensity correspond to the "High, Medium and Low" of the air speed indicator in turn;
2. Upon initial use and re-plugging of the power cord, the default state of the product is "Medium";
3. Consumers may adjust the sensitivity according to the actual situation.

7. Speed

The default is the low wind, which can be switched correspondingly according to the number of presses.

Number of Presses	Wind Status
Press once, twice or 3 times	Respectively medium, high and mute wind
Press 4 times	Low

Tips: Low wind and medium wind are suitable for common cases; and it is recommended to use high wind when booting or there is especially poor indoor air quality.

8. Air Quality Indicator

The "Odor Sensor" in the machine detects pollutants in the air, and prompts them through the indicator.

Blue light- GOOD Orange light- NORMAL Red- BAD

Note: After turning on, the first 3 minutes shall be warm-up time of the sensor, the machine can not detect air quality in the three minutes but shall enter the actual test state after the completion of three minutes of warm-up, and the test results are for reference only.

Tips: The machine uses an odor sensor which is sensitive to hydrogen, carbon monoxide, methane, odor, ethyl alcohol, etc. but insensitive to formaldehyde gas, etc., does not support the detection to dust, pollen and other particles, but does not affect the purifying effect of the above pollutants.

9. Tips:

In the work process, in case the power turns off, the machine will automatically remain at the work status before power failure in the next boot; in case of unexpected power failure, the machine will return to the default state in the nextboot.

Know your Air Purifier (Model - CAF-W50XIN)



Know your Air Purifier (Model - CAF-W50XIN)

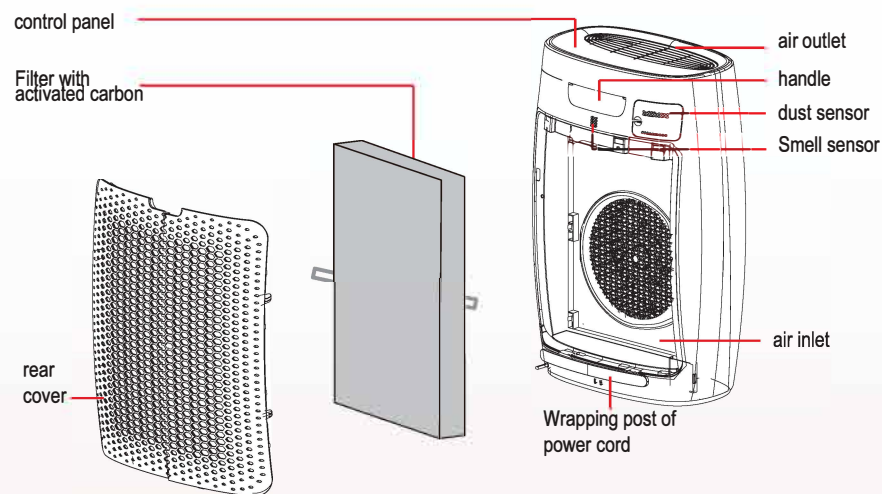

If you will not use Air Purifier for a long term, in order to store conveniently, you should wrap power cord

Note: Please in kind prevail when installing, and pictures and illustrations are only for reference.

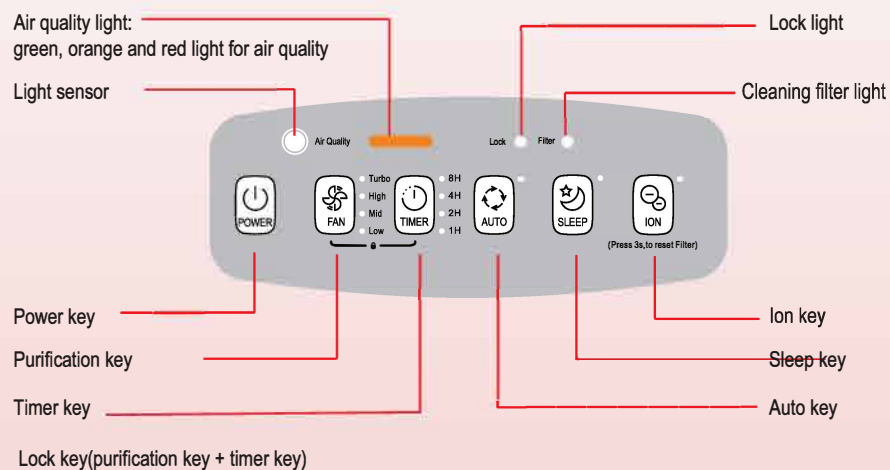

Operation (Model - CAF-W50XIN)

1 Prepare



Tips: Please do not touch power plug with wet hands to prevent electric shock; Please unplug power cable before moving machine.

2 Power



Press "POWER" key, then start purifying



Press the key again, then turn off.

3 Switch of purification



Press "FAN" key

- Turbo
- High
- Mid
- Low

Choose the options of strong, high, medium and low

Tips: Options of low and medium are used normally, while options of high and strong are recommended to use at the beginning of turning on or when the quality of air is poor.

4 Auto Mode

For the auto mode, air purifier adjust purification automatically according to the Data(dust, smell) from sensors. It adjust purification and brightness of indicator Light automatically according to data from environment of light sensor. If environment is dark, it switches to sleeping mode automatically.



Press "AUTO" key, it Switches to auto mode



Press the key again, then cancel.

Operation (Model - CAF-W50XIN)

5 Timer Setting

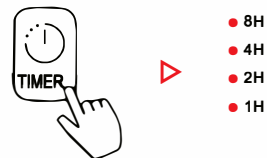

Press "TIMER" key, the timer in turn sets as 1 hour, 2 hours, 4 hours, 8 hours and off, respectively

6 Ion Function

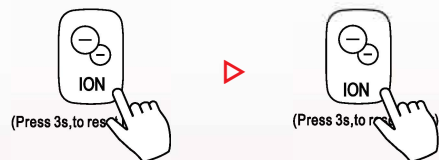

Press "ION" key, then turn on an ion function
Press the key again, the cancel.

7 Clean Filter Function

When cleaning filter light open (Filter), it reminds you that you need to clean filters. After the cleaning, press "ION" key for 3 second, the timer resets from the beginning.

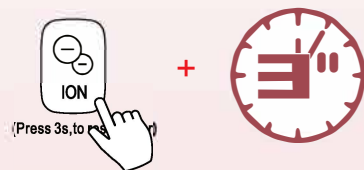

8 Sleeping Mode

For sleeping mode, the light of sleeping mode switch to dark, while other lights turn off, and purification turns to low.

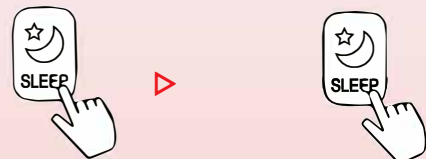

Press "SLEEP" key, then turn on sleeping mode.
Press the key again, the cancel.

Tips: For sleeping mode, it switches to normal operation status by press any key, Press keys for corresponding functions and switches to sleeping mode again if there is no action.

Operation (Model - CAF-W50XIN)

9 Lock Function

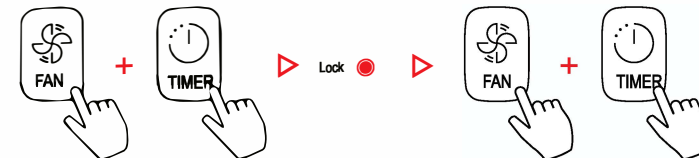

Press "FAN" and "TIMER" at the same time for one second, then turn on lock function. There will be no reaction when press other keys.

Press the key again, turn off lock function.

10 Light Sensor Function

For auto mode, if machines are in dark environment, it switches to sleeping mode automatically. According to light sensors sensing environment is becoming dark.

11 Air Quality Indicator Function

Purifiers sense particles in the air by "dust sensors" and smell by "smell sensor". Air quality indicator light indicates comprehensive air quality.

Air quality	Color air quality indicator light
GOOD	GREEN
NORMAL	ORANGE
BAD	RED

Tips: After purifier turns on, sensors need to preheat for three minutes. After the preheat, it switches to normal status automatically.

NOTE: All the illustrations in the manual are for explanation purpose only. Your machine may be slightly different. The actual shape shell prevail. The design and specifications are subject to change without prior notice for product improvement.

Maintenance

Cleaning of machine body:



Clean machine body, air inlet and air outlet with soft, neat and dry cloth.

Cleaning of filter components:

Clean filter components when cleaning filter turns on.

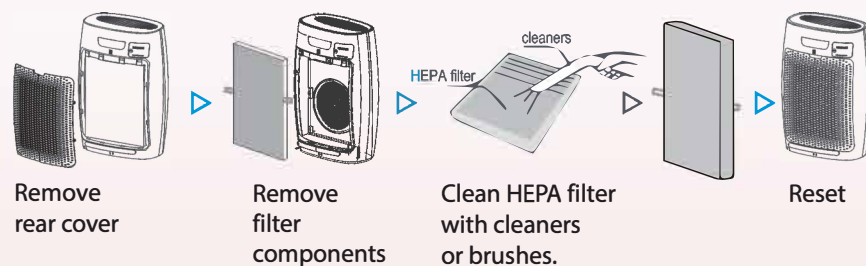

Tips:

- Do not clean composite filter with water;
- Recommend to clean filter with small soft brushes or household cleaners;
- For cleaning filters, only need to clean air inlet side but not rear side (except frames of filters);
- When clean with brushes, clean crosswise and avoid clean vertically to prevent damage of filters.
- When clean with cleaners, keep suction outlets 5-10 mm away from surfaces of filters to prevent damage of filters.

Maintenance

Replacement of filter components:

Recommend to replacement filter components when filter components is broken or filtering effect is poor.

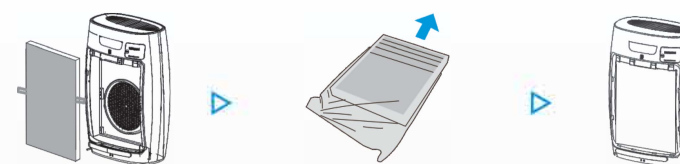

Remove filter components

Replace new filter components

Reset

Tips: Please choose corresponding filters of this model for renewal. Please buy it from dealers.

Cleaning of dust sensor:

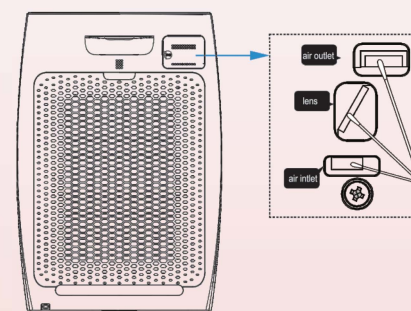

Clean lens, air inlet and outlet wet cotton swabs, while clean remaining water stain on dust sensor with dry cotton swabs.

Tips: Please clean every 2 months in order to ensure normal effect of dust sensor.

Troubleshooting

This section summarizes the most common problems you could encounter with the appliance. If you are unable to solve the problem with the information below, contact the Midea Consumer Care Center

Problem	Possible solution
The appliance does not work even though it is plugged in.	The filter replacement code has been displaying on the screen but you have not replaced the corresponding filter yet. The appliance will be locked if you keep using the expired filter. In this case, replace the filter and reset the filter lifetime counter.
The appliance does not work even though it is switched on.	The filter replacement code has been on continuously but you have not replaced the corresponding filter, and the appliance is now locked. In this case, replace the filter and reset the filter lifetime counter.
The appliance accidentally powers off.	The appliance restarts automatically and goes to the previous mode when the power resumes.
The airflow that comes out of the air outlet is significantly weaker than before.	The pre-filter is dirty. Clean the pre-filter
The air quality does not improve, even though the appliance has been operating for a long time.	One of the filters has not been placed in the appliance. Make sure that all filters are properly installed in the following order, starting with the innermost filter:
	The air quality sensor is wet. The humidity level in your room is high and causes condensation. Make sure that the air quality sensor is clean and dry.

Troubleshooting

Problem	Possible solution
The color of the air quality light always stays the same.	The air quality sensor is dirty. Clean the air quality sensor
The appliance produces a strange smell.	The first few times you use the appliance, it may produce a plastic smell. This is normal. However, if the appliance produces a burnt smell, contact your Midea dealer or an authorized Midea service centre. The appliance may also produce an unpleasant smell when the filter is dirty. In this case, clean or replace the filter concerned.
The appliance is extra loud.	If the appliance is too loud, you can change the fan speed to a lower fan speed level. When using the appliance in a bedroom at night, choose the sleep mode.

E-Waste Management Guidelines

PROPER HANDLING AND/OR RECYCLING OF THE WATER HEATER

Under the E-Waste (Management & Handling) Rules, 2011 (hereafter referred to as the "E-Waste Rules"), it is incumbent for all consumers, including the purchaser of this air purifier, to properly recycle and dispose of all electrical and electronic equipment through authorized recyclers. E-Waste has been defined as "waste electrical and electronic equipment, whole or in part or rejects from their manufacturing and repair process, which are intended to be discarded." E-Waste contains various hazardous materials like lead, mercury, cadmium, hexavalent chromium, polybrominated biphenyls and polybrominated diphenyls ethers. Hence, improper handling and disposal of e-waste releases these hazardous material in the environment causing pollution, contamination of soil and water and various health hazards. Though the product purchased by you does not contain any hazardous material above the prescribed limit under the E-Waste Rules, it is imperative that the product should be handled with utmost caution and as per the guidelines mentioned in this manual including the following Do's and Don'ts —

Do's	Don't's
Hand over the E-Waste to the Company / Authorised recycler	Never sell the e-waste to any unauthorized agencies, scrap dealer/kabadiwalahs.
E-Waste should never be thrown in household bins.	Never throw E-Waste in bins as part of household waste.
Keep the product in isolated area, after it becomes non-functional/un-repairable so as to prevent its accidental breakage.	Never keep E-Waste in open and exposed area, accessible by all.
The product should not be opened by the User himself/ herself, but only by authorised service personnel.	Never open/dismantle any e-waste on your own.

The following marking/symbol on the product or carton indicates that the product and its accessories/parts (e.g. remote controller, batteries, spare parts etc.) should not be disposed of with other household waste at the end of their working life. Please separate these items from other types of waste and recycle them responsibly for conservation of the environment and collective well-being.



Product Warranty Terms & Conditions

Union Distribution s.r.o. (hereinafter referred to as the "Company"), hereby warrants to the original domestic purchaser (here in after called the "Purchaser") of the product (as detailed within the Warranty Registration Card and here in after referred to as the "Said Unit") that the Said Unit is free from defects in materials and workmanship under normal use and service and under specified voltage conditions, and that during a period of twelve (24) months commencing from the date of invoice ("Warranty Period"), as provided in the Warranty Registration Card, the Company undertakes to repair or to replace as it deems fit in sole discretion, free of charge, any part or parts of the Said Unit which proves to be defective in materials or workmanship.

Warranty Exclusions:

This warranty does not cover:

- Noise or vibration that are considered normal for product operations like warning beeps and reject water sound;
- Normal maintenance which is recommended by the user's manual;
- Removal of foreign objects / substances from the machine, including the pump and any set of filters;
- Replace fuses in or correct house wiring or correct house plumbing;
- Any type of painting, plating including rusting etc., or defects thereof;
- Consumable components such as filters and plastic parts.

Conditions of Warranty

- The Purchaser shall promptly notify the Company of any defect(s) noticed and shall allow the Company or its duly authorized agents to inspect, test and carry out necessary repairs;
- At the time of repair/service, the Purchaser is mandatorily required to show the original invoice to the authorized service personnel of the Company. If the Purchaser fails to do so, then all repair work and service shall be carried out on a chargeable basis;
- The Warranty shall be valid only for the Warranty Period irrespective of whether the Said Unit has been in use or not for any reason whatsoever;

Product Warranty Terms & Conditions

4. The Warranty Period shall include time taken for repairs, replacements, testing of unit, technical breakdowns, transit time etc;
5. The Warranty Period shall not be extended, renewed or otherwise affected due to subsequent resale, repair or replacement of the Said Unit. Parts of the Said Unit replaced or repaired under the terms of this warranty are warranted only for the remaining period of the original Warranty Period.
6. For attending any service call under this warranty beyond the Municipal limits of the locality in which the authorized representative/dealer is situated (outstation locations), all to and fro traveling and other incidental expenses as prevailing from time to time incurred in connection with the visit of the service personnel, technicians etc., shall be borne by the Purchaser and shall be payable in advance. Additionally, all expenses incurred by the authorized representative/dealer in collecting the unit or any part thereof from such outstation locations for repair and its return to the original location shall be borne exclusively by the Purchaser.
7. While the Authorized Dealers/Company will make every effort to carry out repair and/or if the part is not repairable then replacement of parts under this warranty as soon as the complaint is received, it is expressly made clear that the Authorized Dealer/Company shall not be liable to do so within any specified period of time.
8. It shall be absolute discretion of the Company to-
 - (a) carry out repairs or replacement of parts whether at the site of installation or at any service center;
 - (b) replace the defective parts by functionally operating equivalent parts which may be different from the one originally fitted.
 - (c) retain any defective part or components replaced under this warranty.
9. Limitation of Warranty:
The Warranty is not applicable in any of the following cases-
 - a. Defects arising due to failure of the Purchaser to follow the instructions given in the User Manual for installing, servicing, cleaning or operating the Said Unit;
 - b. The Said Unit is serviced, repaired, installed, de-installed, re-installed or otherwise attended to by and person other than the authorized representative / Dealer of the Company;
 - c. Any damage/fault caused due to accident, sabotage, tampering, improper handling or treatment, carelessness, accident, fire, flood, earthquake or any act of God, or any corrosive action on the original fittings, valves etc;
 - d. The Said Unit is used for any purpose other than the residential use of the Purchaser;
 - e. Any damage caused by power surges and dips, improper electrical circuit outside the unit or by any defective electrical supply;
 - f. If the Said Unit or any parts thereof is damaged by insects, rats, pests or any other external factors like fire, flood, earthquake, lighting and/or any other act of God/ natural calamities.

Product Warranty Terms & Conditions

- g. Any defect due to substitution of original components with non-genuine components;
- h. Damage to the Said Unit due to use of any ancillary equipment which is not authenticated or recommended by the Company;
- i. The serial number on the unit or any part thereof is damaged, defaced, altered, obliterated, or tampered with or removed for any reason whatsoever;
- j. If the iron content is high (more than 0.3 ppm).
10. The Company shall not in any event be liable for any indirect, incidental or consequential loss or damages to either the said purchaser and/or his property or any other third party arising out of the use or inability to use the Said Unit.
11. The Company shall not be liable for any loss, damage, delay in repairs, and replacement of parts due to factors beyond the reasonable control of the Company;
12. All claims under this Warranty is limited to the repair or replacement of the defective parts only. The liability of the Company under this Warranty shall under no circumstances exceed the price paid by the Purchaser for the Said Unit.
13. None of the employees and/or dealers of the Company have the authority whatsoever to vary the terms and conditions of this warrant .

**THIS WARRANTY IS NOT TRANSFERABLE AND
APPLIES TO ORIGINAL PURCHASER ONLY.**

**COMPLETE THIS RECORD AND KEEP IT
TOGETHER WITH YOUR PURCHASE DOCKET IN
A SAFE PLACE YOU WILL HAVE TO PRODUCE.**

**SHOULD YOU REQUIRE SERVICE UNDER THE
TERMS OF THIS WARRANTY,
PLEASE CONTACT US.**



Memo

WARRANTY CARD

TOSHIBA

Invoice no. : _____ Date of Purchase : _____

Customer Name : _____

Address : _____

Product Name : _____ Model No. : _____

Sr. No. of the Unit : _____

Dealer's Name & Address : _____

Signature of the Dealer : _____ Dealer's Seal : _____

Union Distribution s.r.o.

TOSHIBA

Invoice no. : _____ Date of Purchase : _____

Customer Name : _____

Address : _____

Product Name : _____ Model No. : _____

Sr. No. of the Unit : _____

Dealer's Name & Address : _____

Signature of the Dealer : _____ Dealer's Seal : _____

Union Distribution s.r.o.



Manuál stažený ze stránek LoveAir.cz